

# Undercounter Tables

## UNDERCOUNTER REFRIGERATOR TABLES WITH DRAWERS



### BUILT TO PERFORM, DESIGNED TO DELIVER

The Asber ATR Premium Line Undercounter Refrigerators represent the next generation of professional refrigeration—engineered for greater storage capacity, superior temperature control, and lasting durability. Featuring an exclusive base design that provides over 30% more interior space than most units in their class, these tables maximize usable storage without increasing footprint.

### INSULATION & ENERGY EFFICIENCY

#### High Performance, Environmentally Responsible Design

- Ecomate™ insulation: Industry-leading, eco-friendly technology (ODP-0, GWP-3) for exceptional temperature retention and energy savings.
- Maximum thermal efficiency: 2" thick insulation throughout.

### REFRIGERATION SYSTEM & PERFORMANCE

#### Efficient, Reliable, and Environmentally Friendly

- R290 Hydrocarbon refrigerant: Delivers quicker temperature recovery and lower energy consumption, ensuring environmental responsibility.
- Reversible Condensing Fan Motor: Ensuring optimal airflow, reduced maintenance, and improved long-term efficiency.
- Hermetic compressor system with epoxy-coated evaporator provides long-lasting performance and corrosion resistance operation.
- Electronic controller provides accurate, easy-to-monitor temperature management.
- Temperature range: Maintains 32°F to 38°F in ambient conditions up to 100°F and 65% RH.

### CONSTRUCTION & FEATURES

#### Durable, Safe, and Easy to Maintain

- Exclusive base design increases interior capacity by over 30% compared to standard models.
- Field-reversible doors on solid single-door models for flexible installation.
- Designed for space optimization, fitting seamlessly beneath standard countertops or work surfaces.

### DRAWER SYSTEM & STORAGE FLEXIBILITY

#### Heavy-Duty, Hygienic, and Operator-Friendly

- Factory-installed stainless-steel drawer kits for maximum flexibility.
- All-stainless-steel drawers: Built for durability and ease of use, providing long-lasting performance in busy kitchen environments.
- High-strength slides: Designed for smooth operation and dependable support under heavy use, rated for up to 88 pounds per drawer.
- Flexible configurations: Each drawer accommodates pan sizes from 1/9 to 1/1, up to 6" deep (pans sold separately).
- Fixed pan dividers: ensure stable pan positioning, reducing cross-contamination risk and keeping ingredients perfectly organized for a clean and efficient workflow.

### OPERATOR-FOCUSED DESIGN

#### Ergonomic, Practical, and Sanitary

- Full-length recessed handles: Provide ergonomic access while maintaining a clean, professional appearance.
- In-step interior design: provides a superior door seal, reducing energy loss, and preventing condensation.
- Magnetic one-piece door gaskets: Ensure a tight seal to preserve internal temperatures; tool-free removable, simplifying cleaning and maintenance.
- Standard 5" casters (front with brakes) provide stability, mobility, and easy access for cleaning and maintenance.

### CERTIFICATIONS

- NSF-7 Certified: Meets rigorous food safety and sanitation standards.
- ETL Listed: Certified for electrical and mechanical safety.
- DOE Compliant: Meets U.S. Department of Energy efficiency standards.

### OPTIONS & ACCESSORIES

- Overshelf.
- Extra shelves.
- 3" Casters.
- 4" Stainless-steel backsplash.



AUTR 27 D2 P



AUTR 48 D2 P



AUTR 60 D4 P

MODEL	DOORS	DRAWERS	CAPACITY ft <sup>3</sup>	VOLTS - FREQUENCY	POWER HP	AMP	EXTERIOR DIMENSIONS (in)			SHIPPING	
							Width	Depth	Height	Lbs	ft <sup>3</sup>
UNDERCOUNTER REFRIGERATOR TABLES WITH DRAWERS											
AUTR 27 D2 P	0	2	9.5	115V. - 60Hz.	1/10	1.5	27-3/4	30-1/8	35-3/4	201	24.7
AUTR 48 D2 P	1	2	16.7	115V. - 60Hz.	1/4	2.5	48-3/8	30-1/8	35-3/4	280	42.4
AUTR 48 D4 P	0	4	16.7	115V. - 60Hz.	1/4	2.5	48-3/8	30-1/8	35-3/4	280	42.4
AUTR 60 D2 P	1	2	20.6	115V. - 60Hz.	1/4	2.5	60-3/8	30-1/8	35-3/4	302	53.0
AUTR 60 D4 P	0	4	20.6	115V. - 60Hz.	1/4	2.5	60-3/8	30-1/8	35-3/4	302	53.0
AUTR 72 D2 P	2	2	25.4	115V. - 60Hz.	1/4	2.5	72-1/2	30-1/8	35-3/4	359	63.6
AUTR 72 D4 P	1	4	25.4	115V. - 60Hz.	1/4	2.5	72-1/2	30-1/8	35-3/4	359	63.6
AUTR 72 D6 P	0	6	25.4	115V. - 60Hz.	1/4	2.5	72-1/2	30-1/8	35-3/4	359	63.6

SPECIFICATIONS ARE SUBJECT TO CHANGE WITHOUT PRIOR NOTICE. | HEIGHT INCLUDES 6" CASTERS. | VALID ONLY FOR CONTINENTAL USA & CANADA.

# Undercounter Tables

UNDERCOUNTER REFRIGERATOR TABLES WITH DRAWERS

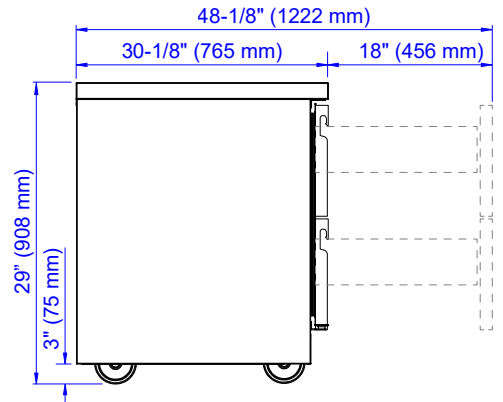
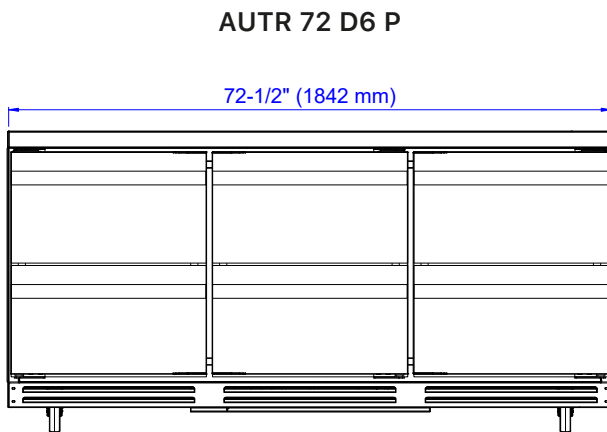
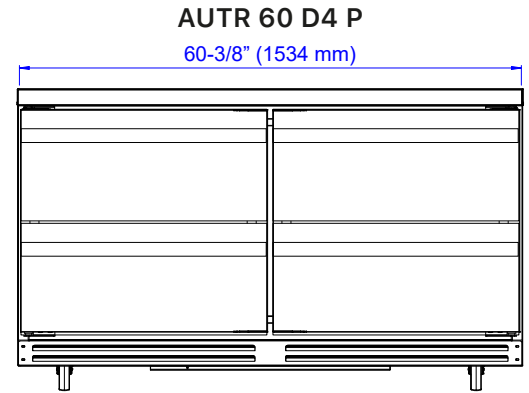
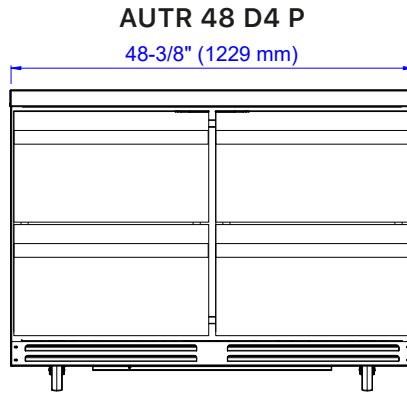
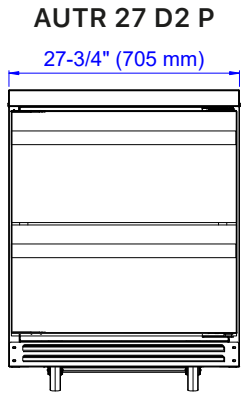

MODEL	AUTR 27 D2 P	AUTR 48 D4 P	AUTR 60 D4 P	AUTR 72 D6 P
<b>ELECTRICAL DATA</b>				
Volts - Frequency	115V. - 60Hz.			
Power (HP)	1/10			1/4
Full Amp Load	1.5			2.5
Plug Type	NEMA 5-15P			
Refrigerant	R290			
<b>SHIPPING DIMENSIONS (in)</b>				
Width	31-1/2	52	64-1/8	76
Depth	33-1/2			
Height	43-1/4			



## INSTALLATION REQUIREMENTS

- ELECTRICAL CONNECTION:** Units pre-wired at factory with chord and NEMA 5-15P plug set included for 115/60/1 phase.
- REFRIGERANT:** R290 is classified as A3 flammable refrigerant; risk of fire or explosion due to puncture of refrigerant tubing; follow handling instructions carefully.
- RESIDENTIAL APPLICATIONS DISCLAIMER:** Asber assumes no liability for parts or labor coverage for component failure, factory defect or any other damages for units installed in non-commercial foodservice or residential applications.

SPECIFICATIONS ARE SUBJECT TO CHANGE WITHOUT PRIOR NOTICE. | HEIGHT INCLUDES 6" CASTERS. | VALID ONLY FOR CONTINENTAL USA & CANADA.